

PROSPETTI LOCULI E OSSARI
DI PROGETTO
scala 1:100

QUADRO D'INSIEME
PIANO INTERRATO

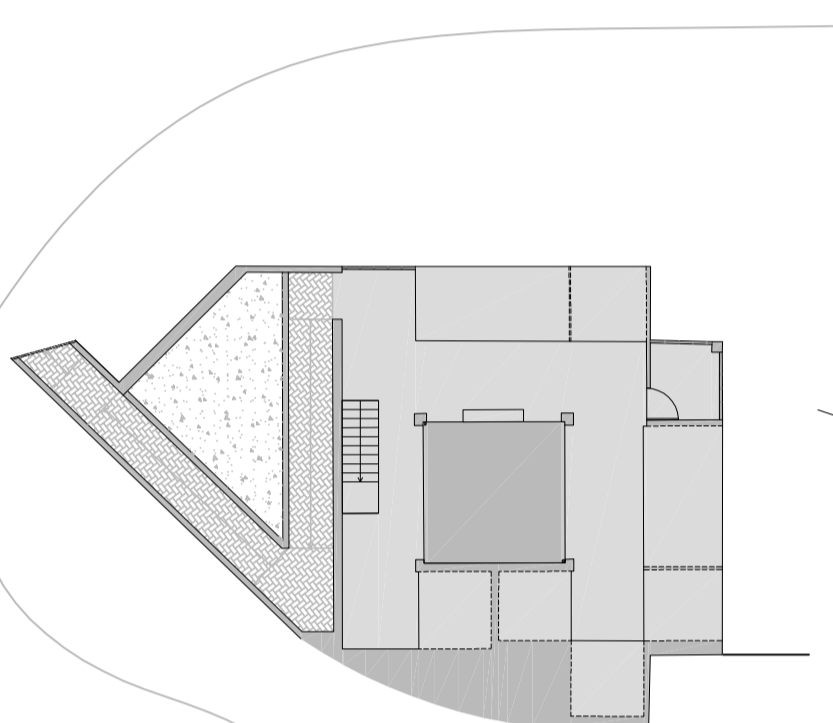

QUADRO D'INSIEME
PIANO TERZA

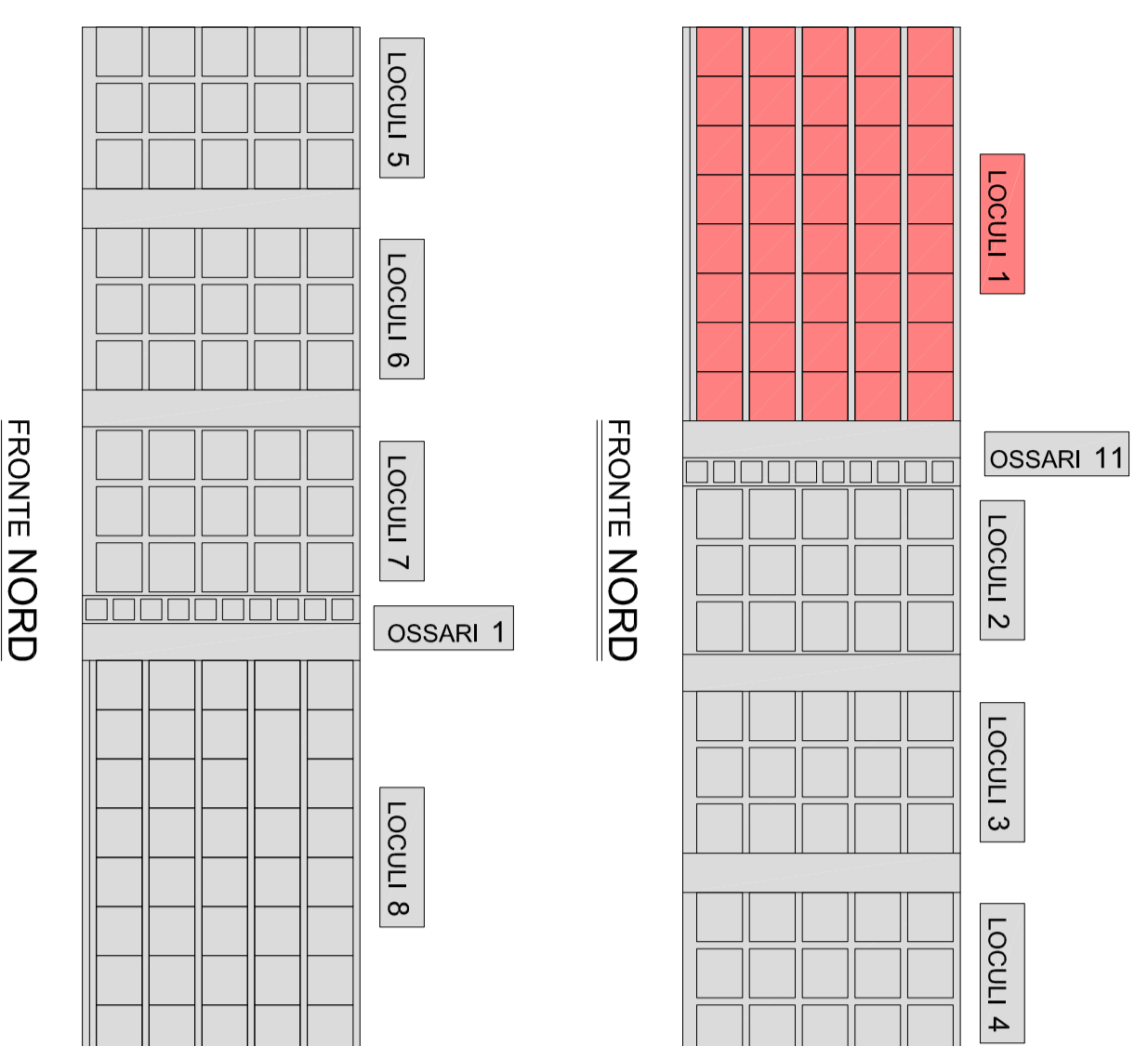
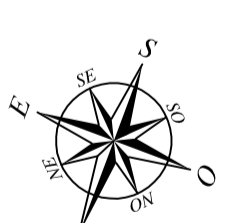

LEGENDA
 Trasformazione di loculi in ossari da 4 posti
 Nuovi ossari/urne cinerarie di progetto

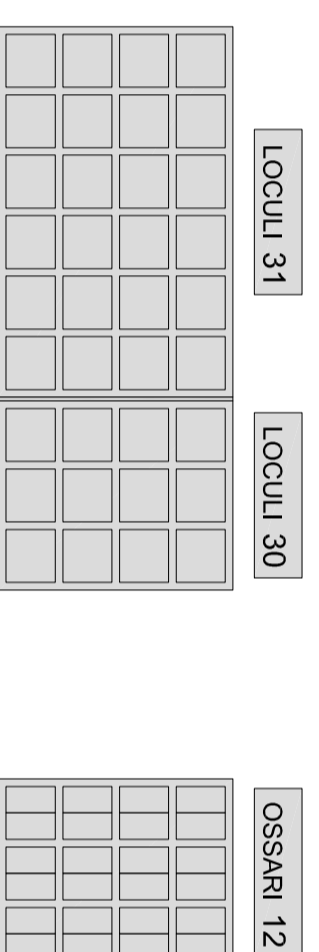
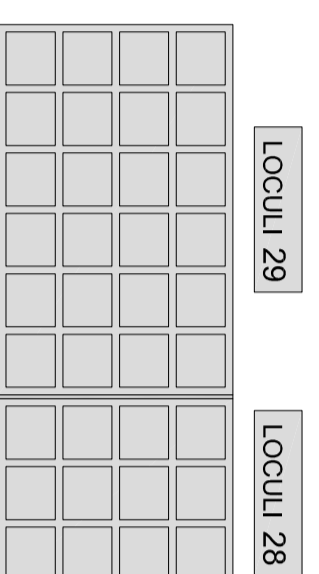
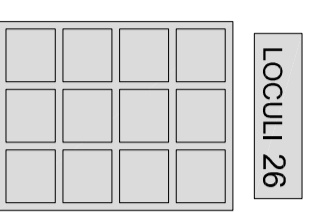
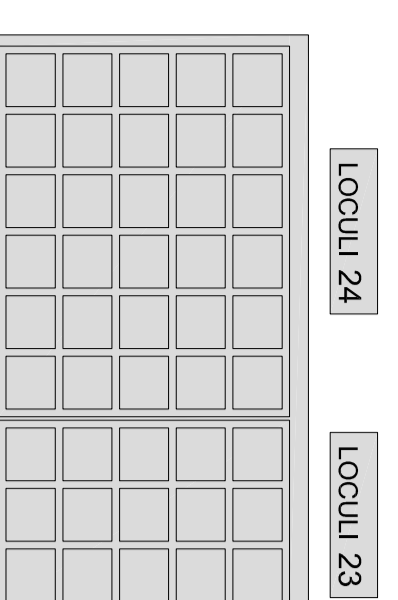
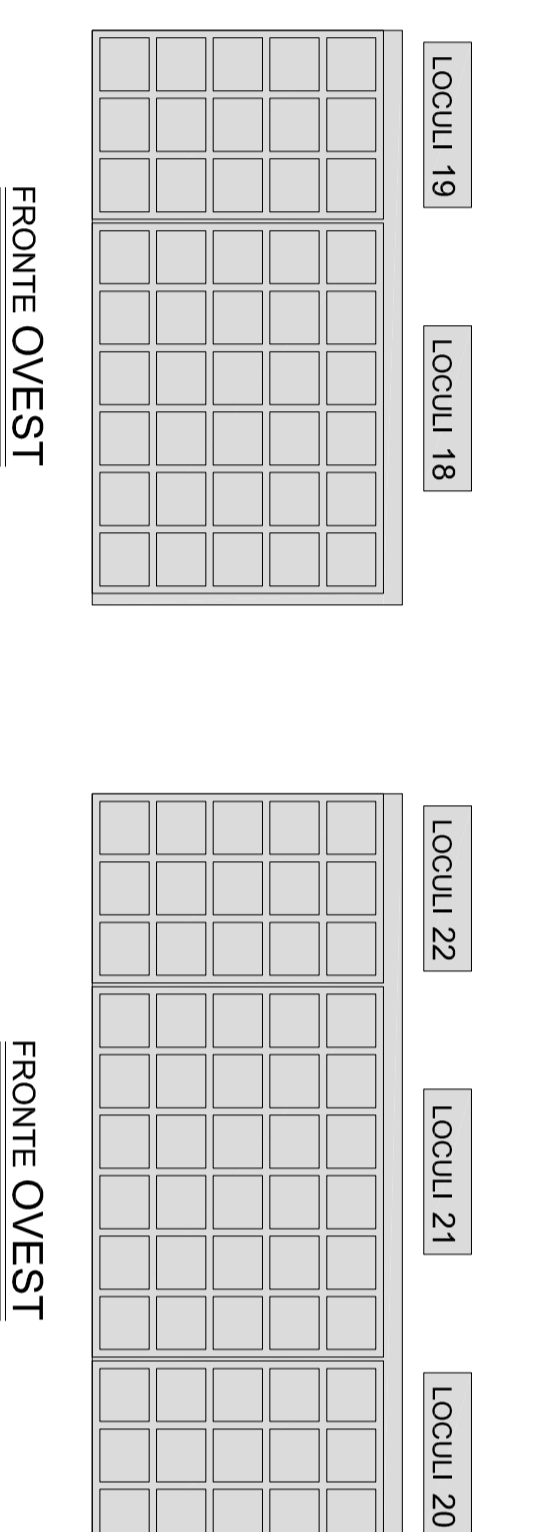
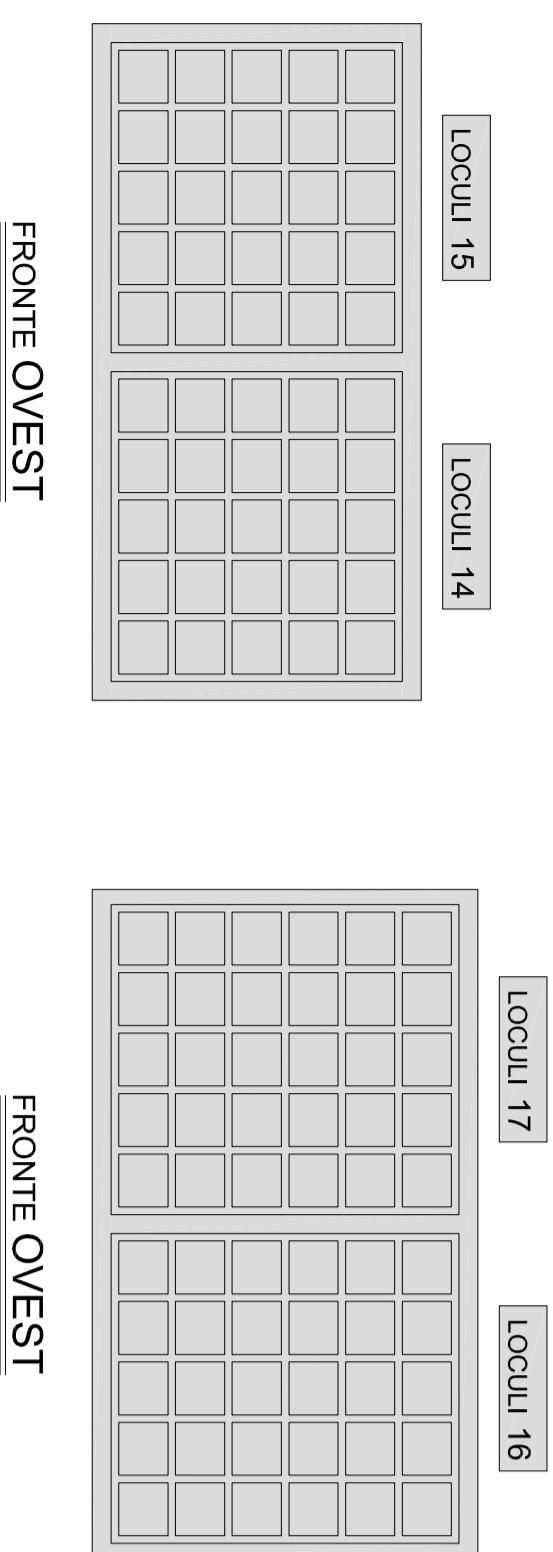
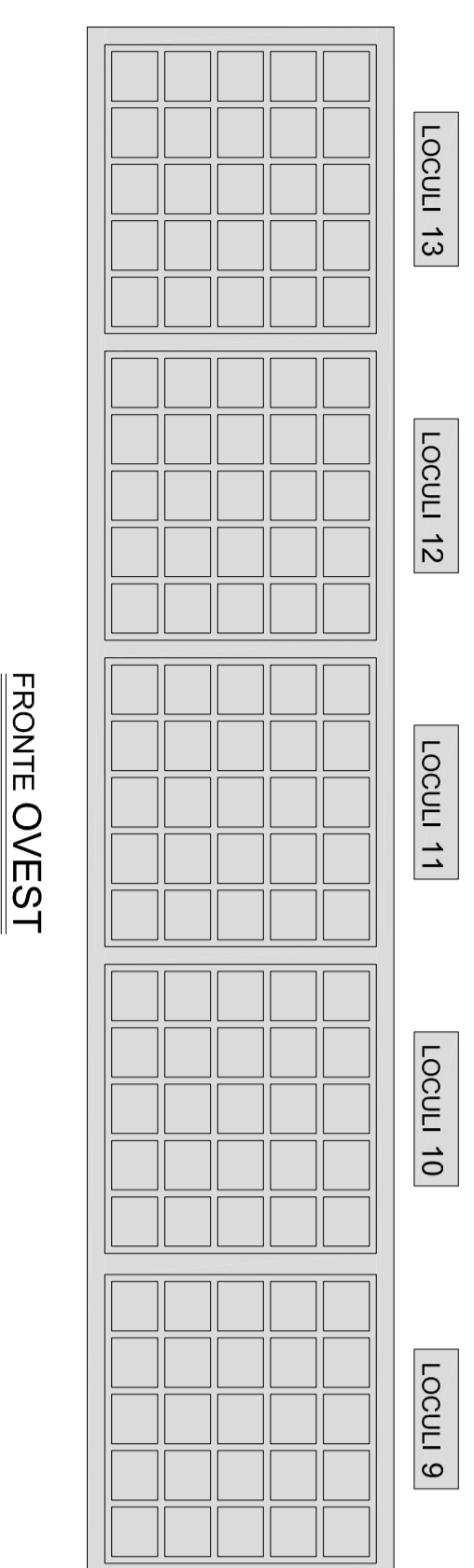

FRONTE OVEST

PIANO INTERRATO FRONTE OVEST

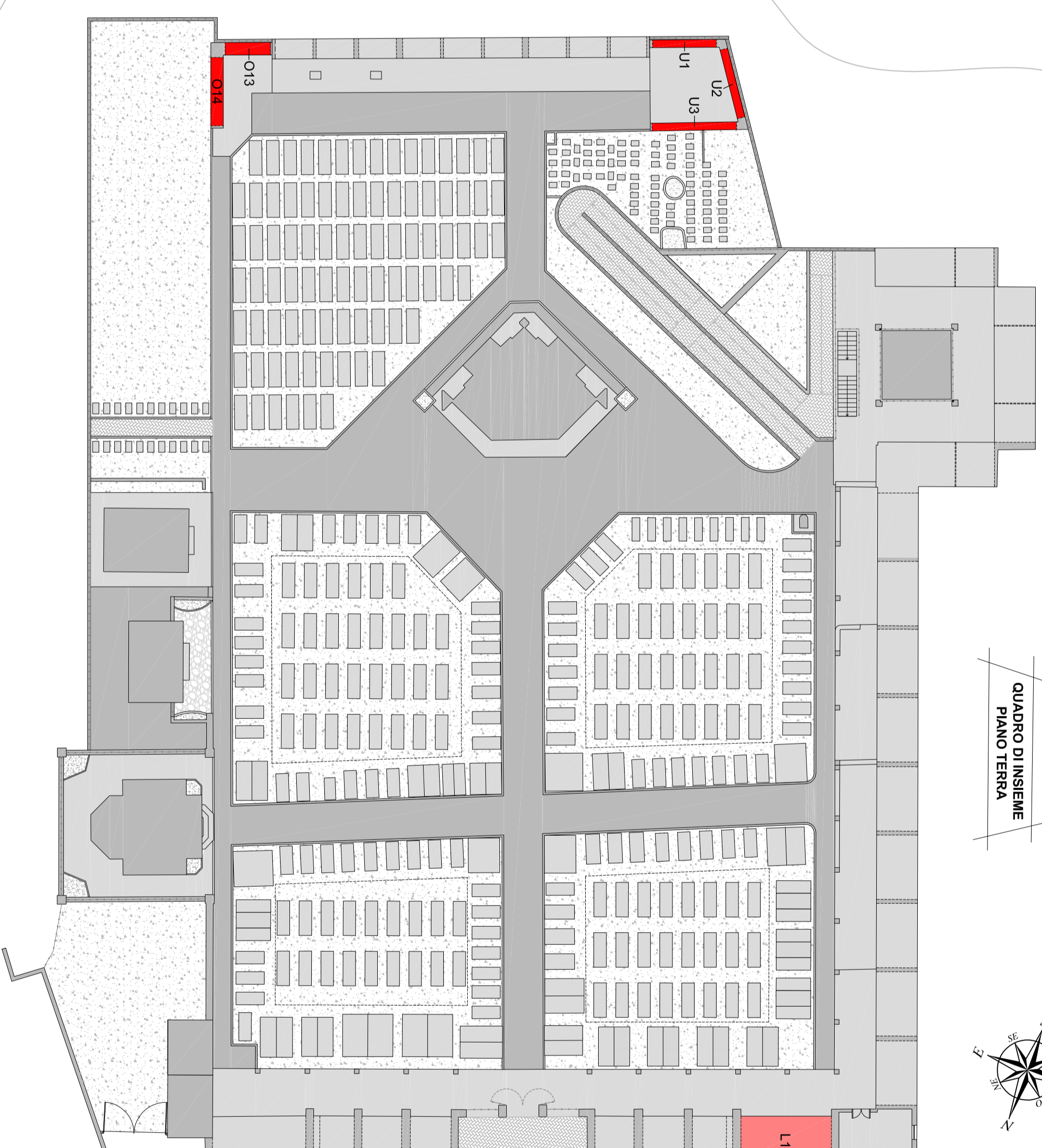
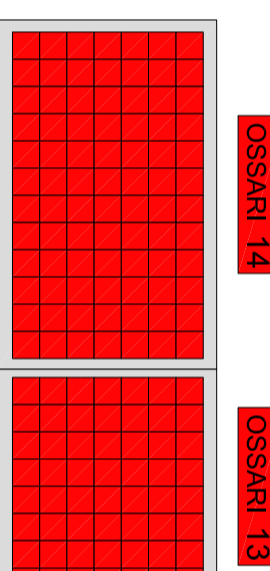
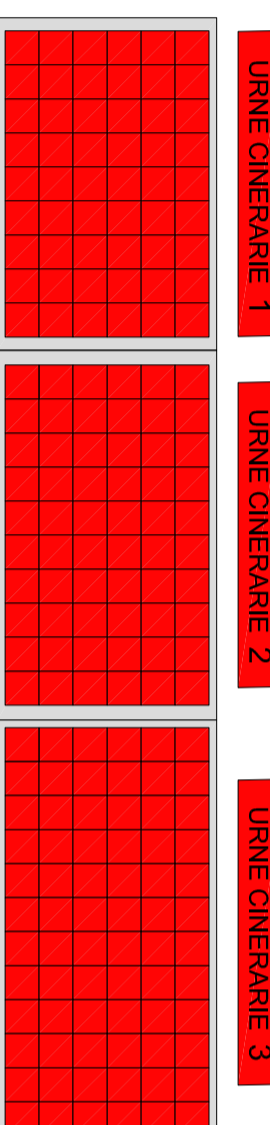
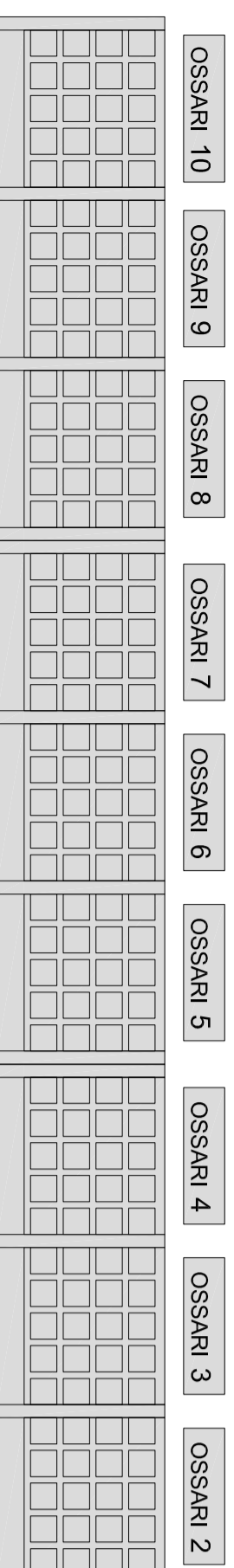

Studio Tecnico
Prodotto Ambiente di Stefano Geom. Pierozzini
Via A. Ponzetti n°8 - 24027 Nembro BG
Tel. 0354127017 Fax: 035.41.27599
E-mail: info@studioprogettisambiente.com
Pec: stefano.pierozzini@ecoproc.it



PIANO REGOLATORE CIMITERIALE
(ai sensi art. 6 R.R. 9 Novembre 2004 n° 6)
CIMITERO ALZANO SOPRA



Tavola numero
9B2

SCALA - Varie
DATA - Giugno 2020

APPROVATO con Delibera C.C. N° del

PROSPETTI LOCULI E OSSARI
DI PROGETTO CON INTERVENTI
DA REALIZZARE