

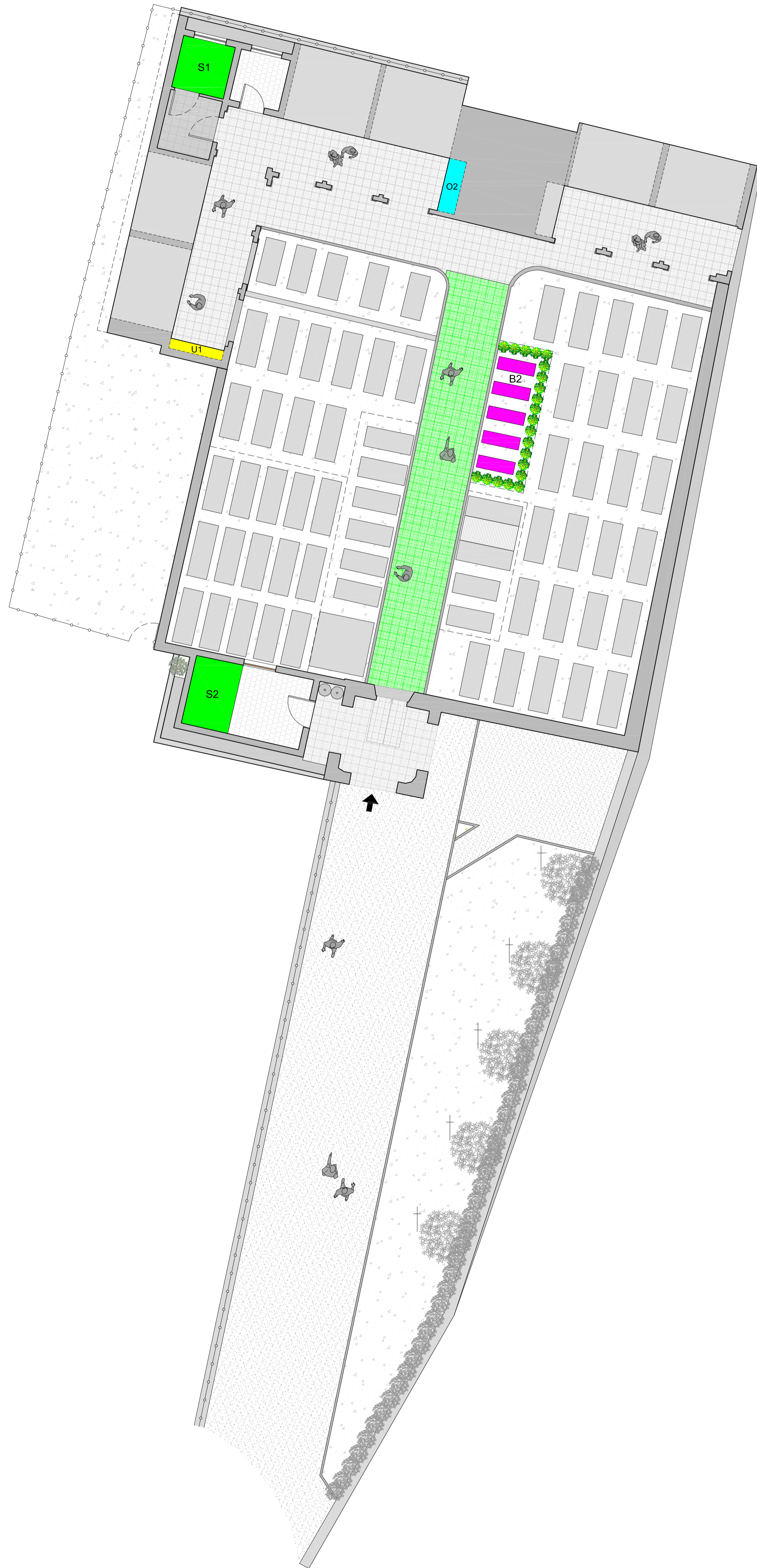

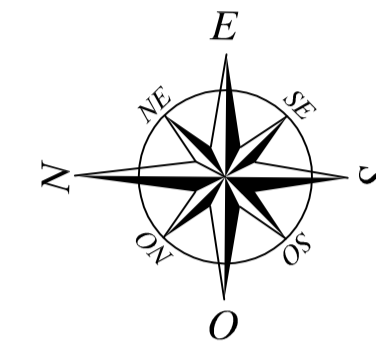



PLANIMETRIA DI PROGETTO
scala 1:100



- LEGENDA
PRIORITA' DEGLI INTERVENTI:
-  Aree verdi e piantumazione di progetto
 -  Fase 1: opere urgenti da realizzare
 -  Fase 2
 -  Fase 3
 -  Fase 4

Studio Tecnico
PROGETTO AMBIENTE di
Stefano Geom. Pierazzini
Via A. Paschielli n°8 - 24027 Nembro BG
Tel: 035.4127037 Fax: 035.4127549
E-mail: info@studioprogettoambiente.com
Pec: stefano.pierazzini@geopcs.it



Comune di
Alzano Lombardo

PIANO REGOLATORE CIMITERIALE
(ai sensi art. 6 R.R. 9 Novembre 2004 n° 6)
CIMITERO OLERA



Tavola numero
10D

APPROVATO con Delibera C.C. N° del

SCALA - 1:100

DATA - Giugno 2020

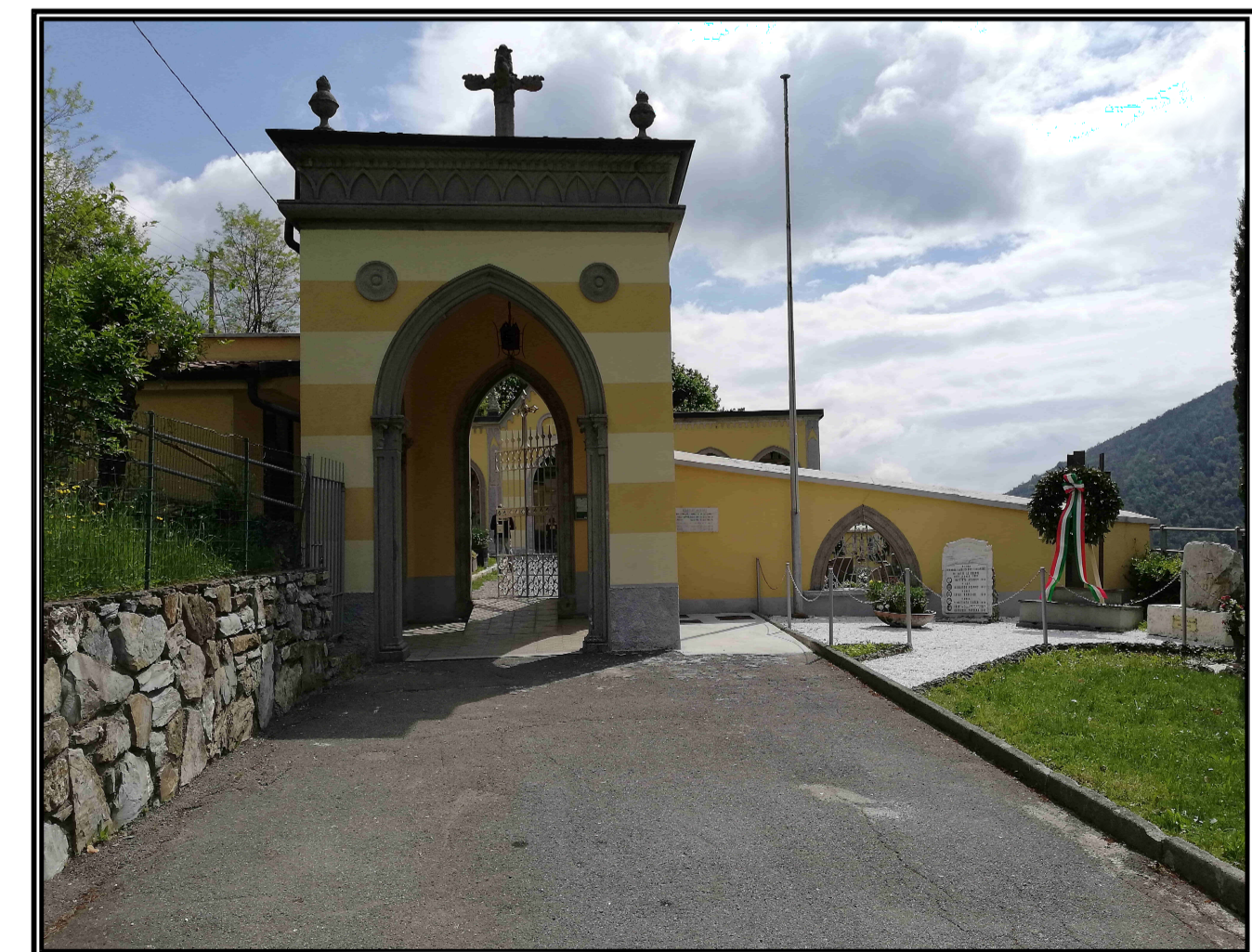
PLANIMETRIA PRIORITA'
DEGLI INTERVENTI